

SIOL-LENS

INSTALLATION INSTRUCTIONS

Continuous Run Installation

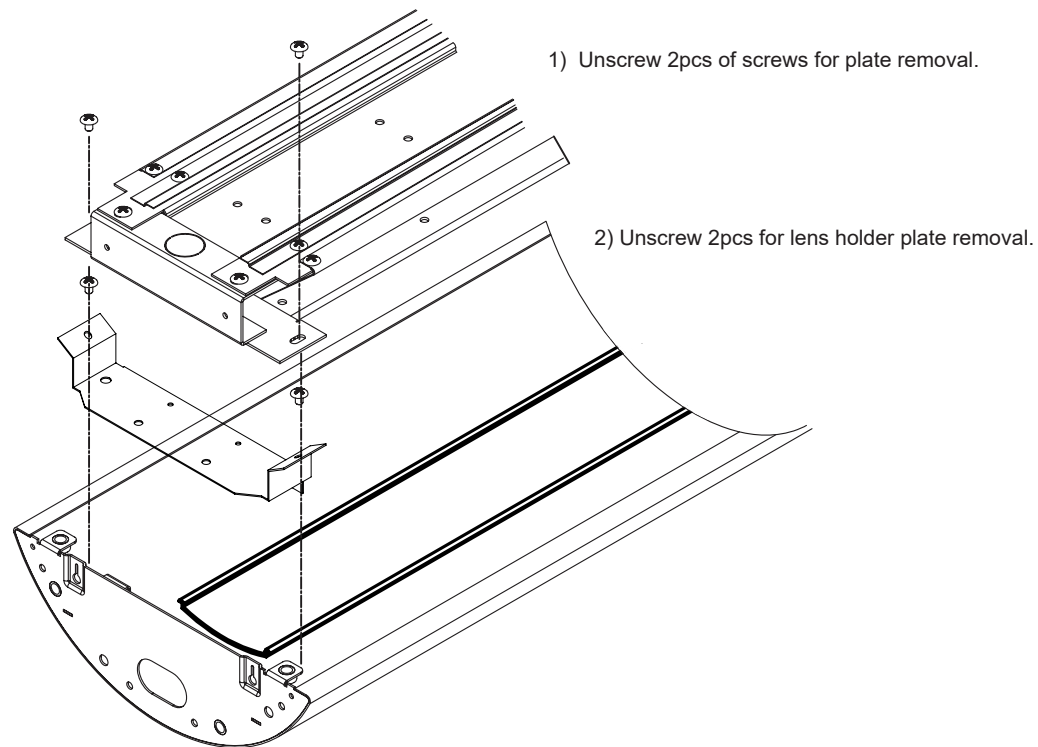
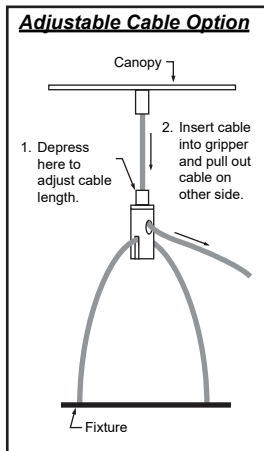
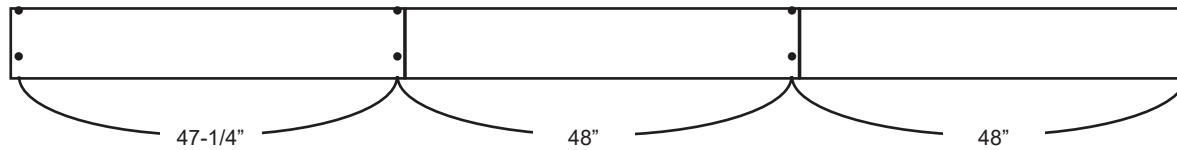

SIOL-LENS

INSTALLATION INSTRUCTIONS

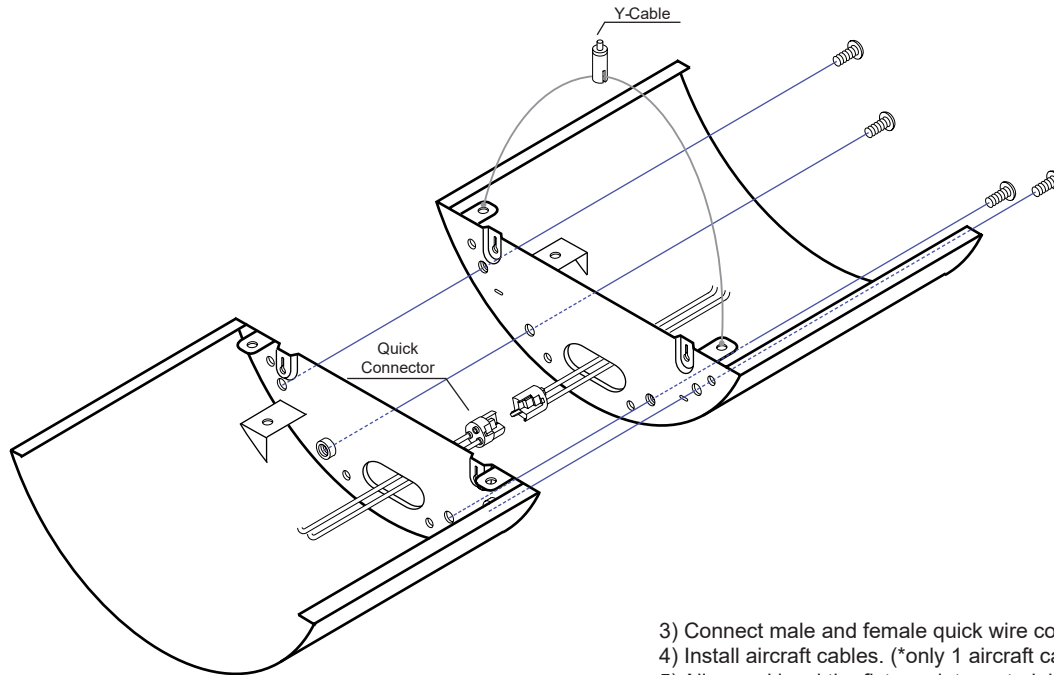

- 3) Connect male and female quick wire connectors.
- 4) Install aircraft cables. (*only 1 aircraft cable at each continuous joint is recommended)
- 5) Align and level the fixtures into a straight row and bolt fixture together.
- 6) Reinstall lens holder plate & module plate back.



866-471-7711
utopialighting.com
info@utopialighting.com

Contractor is responsible for adequately reinforcing ceilings to support luminaire weight. Utopia Lighting accepts no responsibility for inadequately reinforced ceilings. The information contained in this drawing is the sole property of Utopia Lighting. Any reproduction in part or whole is prohibited and warranty voided.

WARNING:



RISK OF FIRE AND ELECTRICAL SHOCK. FIXTURE MUST BE INSTALLED BY A QUALIFIED ELECTRICIAN ONLY IN ACCORDANCE WITH NATIONAL, LOCAL BUILDING AND ELECTRICAL CODES. DISCONNECT POWER AT ELECTRICAL PANEL BEFORE SERVICING.